



# Horizontal Beer Frosters



**FROSTER-B-25-HC**  
 Height ..... 33.63"  
 Length ..... 26.00"  
 Depth ..... 27.25"



**FROSTER-B-50-HC**  
 Height ..... 33.63"  
 Length ..... 51.25"  
 Depth ..... 27.25"



**FROSTER-B-65-HC**  
 Height ..... 33.63"  
 Length ..... 66.25"  
 Depth ..... 27.25"

## Features

- Cabinet made of galvanized steel, internally reinforced to support the full weight of the beer bottles
- Full color decals to attract consumers at the point of sale
- Available with black exterior - no decals
- Top and sliding doors constructed of stainless steel
- UL Classified to ANSI/NSF 7
- Self contained heavy duty R 290 condensing unit
- Forced air evaporator for rapid temperature "Pull Down"

Model No.	Description	Voltage	Amps	Temp	HP	Est. Ship Weight
Froster-B-25-HC	1 Door/135 Bottles	115/60Hz/1	2.2	23°F - 33°F	1/5	178#
Froster-B-50-HC	2 Door/402 Bottles	115/60Hz/1	3.1	23°F - 33°F	1/3	284#
Froster-B-65-HC	3 Door/511 Bottles	115/60Hz/1	9.2	23°F - 33°F	1/2	348#





# Technical Data / Horizontal Beer Frosters

MODEL #	FROSTER-B-25-HC	FROSTER-B-50-HC	FROSTER-B-65-HC
<b>OUTSIDE DIMENSIONS</b>			
Depth	27.25"	27.25"	27.25"
Length	26.00"	51.25"	66.25"
Height	33.63"	33.63"	33.63"
Door Size	22.312" x 13.375"	(1) 30.5" x 13.375" (1) 16.85" x 13.375"	(2) 22.625" x 13.375" (1) 16.85" x 13.375"
Door Type	1 sliding	2 sliding	3 sliding
<b>INSIDE DIMENSIONS</b>			
Depth	22.50"	22.50"	22.50"
Length	21.25"	46.50"	61.50"
Height	22.50"	22.50"	22.50"
# of 12oz Bottles	135	336	480
Dividers Included	0	2	2
Capacity: Cubic Foot	5	15	21
<b>SPECIFICATIONS</b>			
Operating Temperature	23°F-33°F	23°F-33°F	23°F-33°F
Refrigerant	R 290	R 290	R 290
Compressor Size HP	1/5	1/3	1/2
Defrost	3 @ 30 min.	3 @ 30 min.	3 @ 30 min.
Voltage	115V/60Hz/1	115V/60Hz/1	115V/60Hz/1
Amperage	2.2	3.1	9.2
Cord and Plug	yes	yes	yes
<b>SHIPPING DIMENSIONS</b>			
Depth	31.00"	31.00"	31.00"
Length	31.00"	56.00"	71.00"
Height	40.00"	40.00"	40.00"
Gross Weight lbs.	178	284	348
Cubic feet	22	40	51

- Cases are designed to operate at 75°F and 55% relative humidity.
- Specification subject to change without notice.

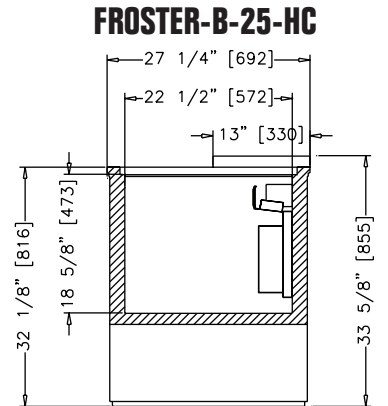

Side View

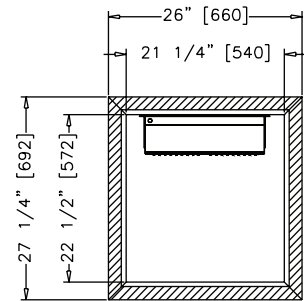

Plan View

## FROSTER-B-65-HC

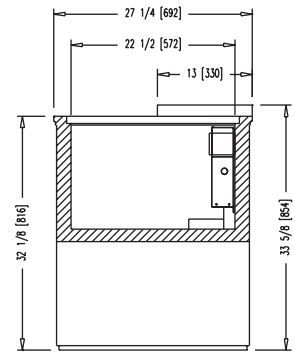

Side View

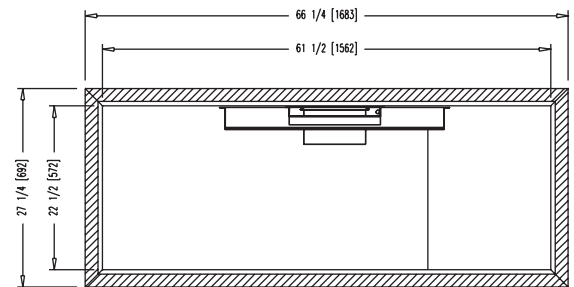

Plan View

## FROSTER-B-50-HC

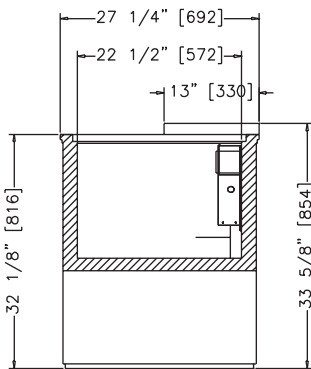

Side View

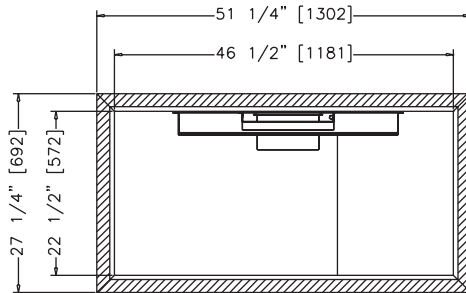

Plan View