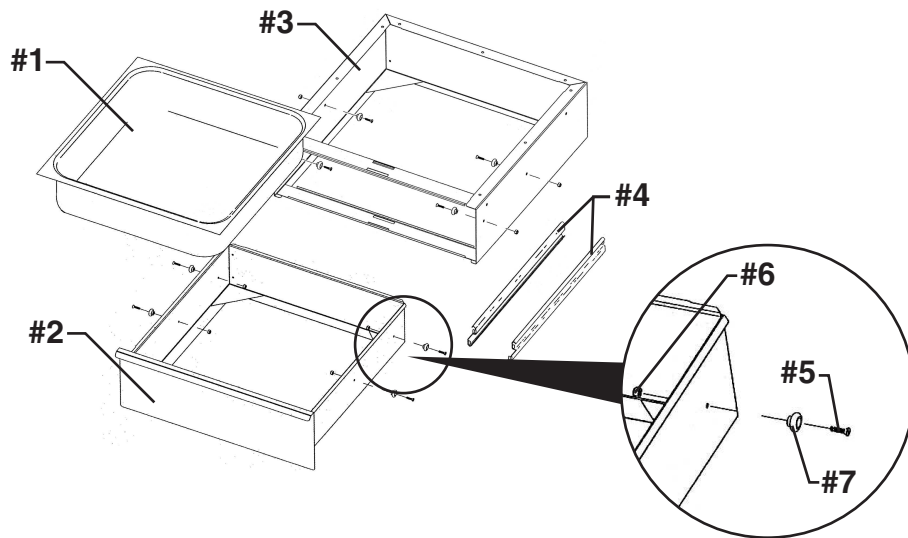

Drawers with NSF Slides**ASSEMBLY INSTRUCTIONS****CAUTION**

INSPECT CONTENTS IMMEDIATELY AND FILE CLAIM WITH DELIVERING CARRIER FOR ANY DAMAGE.

SAVE YOUR BOX AND ALL PACKING MATERIALS.

YOU ARE RESPONSIBLE FOR DAMAGE TO YOUR UNIT IF RETURNED IMPROPERLY PACKED.

Parts List

#	qty	description
#1	1	drawer pan
#2	1	drawer frame
#3	1	drawer enclosure
#4	1	pair of slides
#5	8	bolts
#6	8	nuts
#7	8	bearings

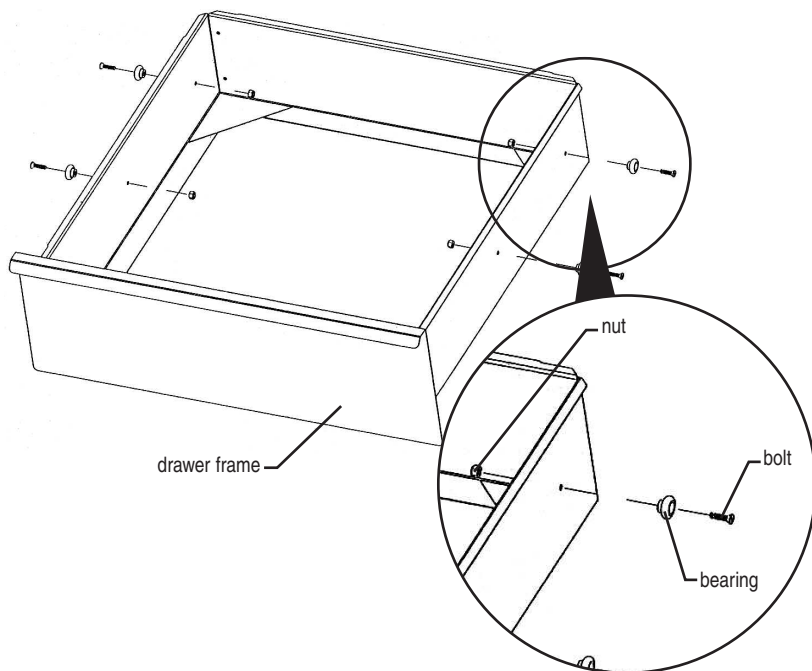
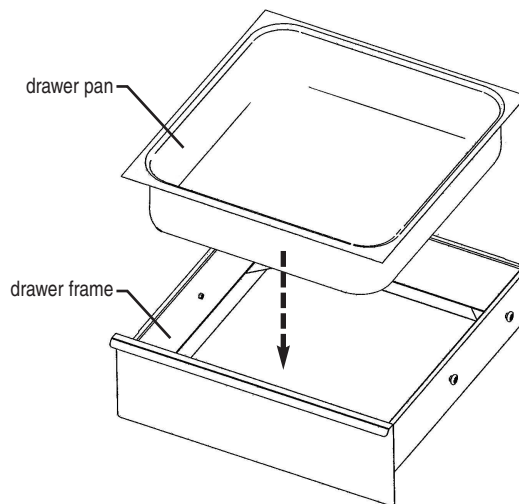
Step 1 - Attach bearings to drawer frame.**Step 2 - Drop drawer pan into drawer frame.**

(continued on back page)

EG9967 Revised 04/08



Profit from the Eagle Advantage®

• 100 Industrial Boulevard, Clayton, Delaware 19938-9905 U.S.A. • www.eaglegrp.com
 • Phone: 302/653-3000 • (Foodservice) 800/441-8440 • (MHC/Retail) 800/637-5100
 • Fax: 302/653-2065

Eagle Foodservice Equipment, Eagle MHC, SpecFAB, and Retail Display are divisions of Eagle Group. ©2008 by the Eagle Group

Drawers with NSF Slides

ASSEMBLY INSTRUCTIONS

Step 3 - Attach bearings to drawer enclosure.

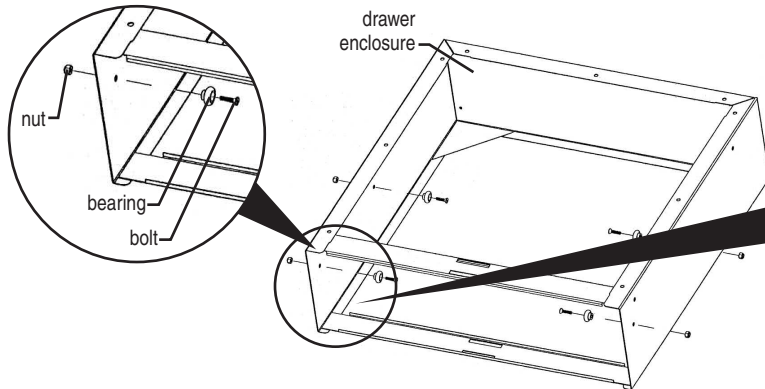

Step 4 - Attach slides to drawer enclosure.

Hang slides on bearings.

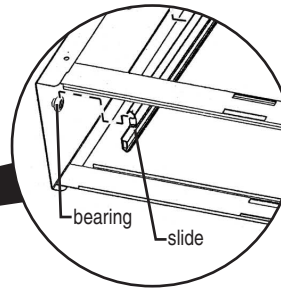

Step 5 - Attach drawer enclosure to hat channels underneath adjoining table.

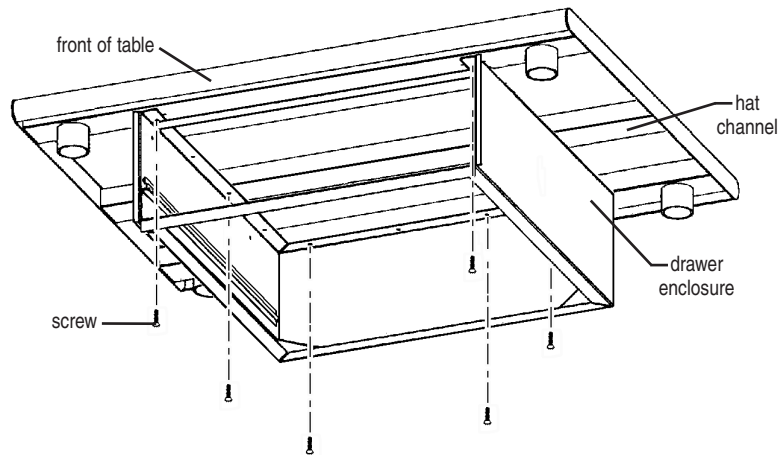

Step 6 - Place drawer pan assembly into drawer enclosure.

- On drawer enclosure, extend slides out as far out as possible.
- Lower rear bearings of drawer pan assembly into slides.
- Slide drawer pan assembly rearward to allow front bearings into slides.

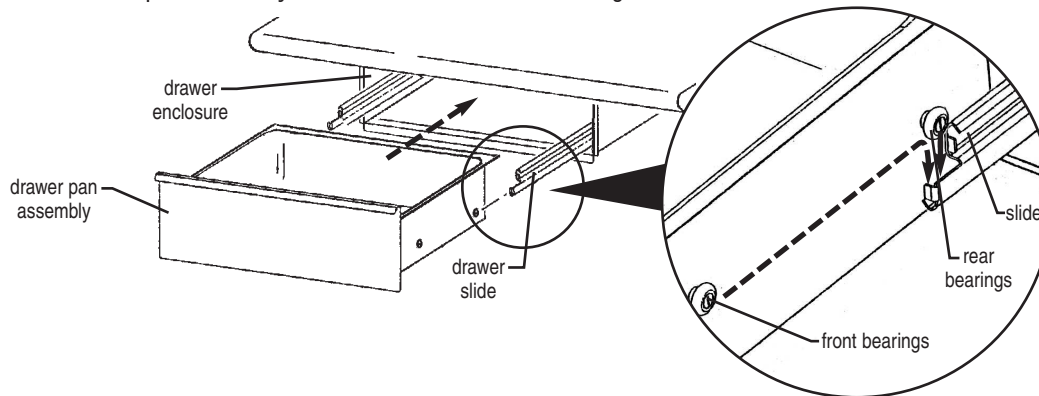

(End)