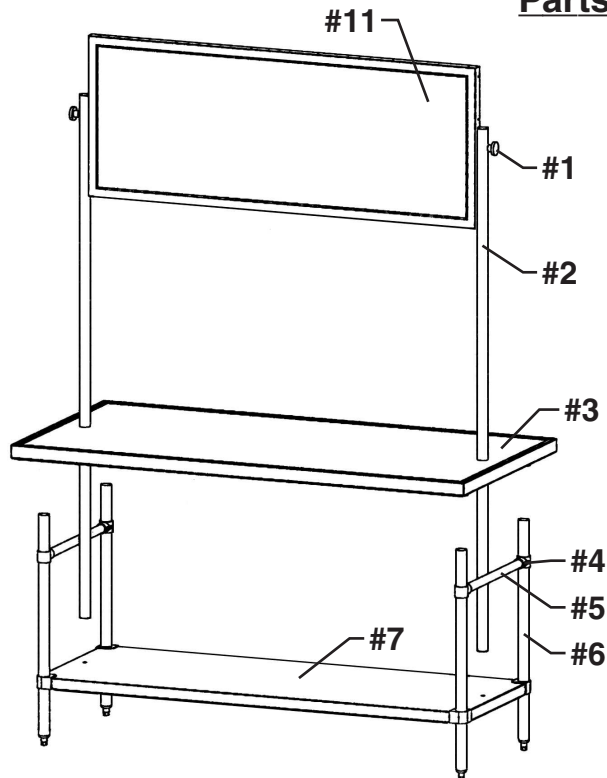

ASSEMBLY INSTRUCTIONS**CAUTION**

INSPECT CONTENTS IMMEDIATELY AND FILE CLAIM WITH DELIVERING CARRIER FOR ANY DAMAGE.
SAVE YOUR BOX AND ALL PACKING MATERIALS.
 YOU ARE RESPONSIBLE FOR DAMAGE TO YOUR UNIT IF RETURNED IMPROPERLY PACKED.

Parts List

item #	qty	part #	description
#1	2	332094	3/8 - 16 x 3" hand knob
#2	2	YTR10231-02	78 3/8" leg
#3	1	*	tabletop
#4	4	317646	crossbrace fitting
#5	2	317643	crossbrace tubing
#6	4	300317	33" leg
#7	1	*	undershelf
#8	2	304143	1/2 - 13 x 2 1/2" hexcap bolt
#9	4	311243	5/16 - 24 set screw
#10	4	305010	3/8" washer
#11	1	*	mirror

* Part number varies by length of table ordered.

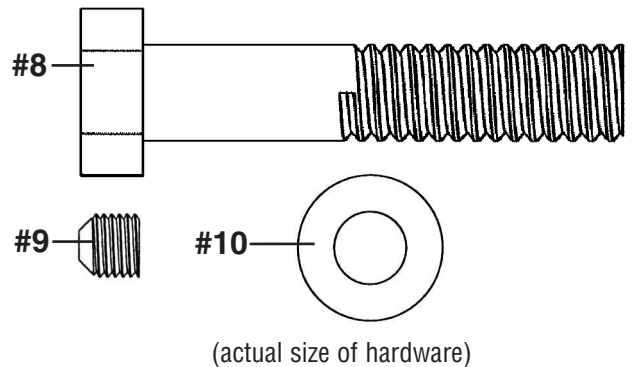

Before assembly: This will be a two-person assembly. Do NOT try to assemble alone.

Step 1 - Assemble 33" legs to undershelf.

- Be sure undershelf is level.
- Recommended height from the floor to the top of the undershelf is 10".

NOTE: Locking bolt found inside each casting. Do not overtighten castings or failure will occur. Use 1/2" allen wrench (not shown).

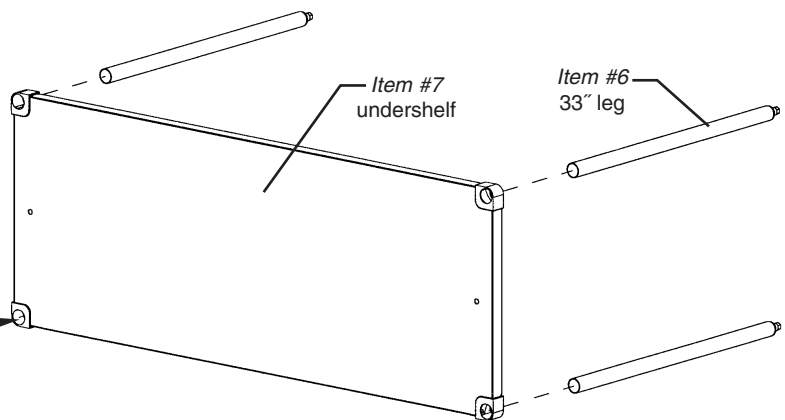

(continued on back page)

EG9969 Revised 10/05

Demo Tables

ASSEMBLY INSTRUCTIONS

Step 2 - Assemble crossbrace tubing and crossbrace fittings.

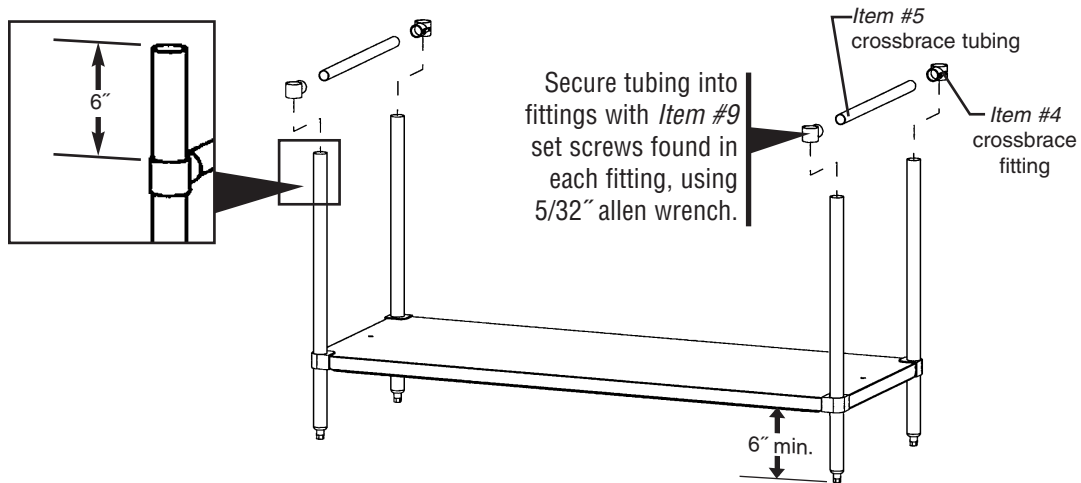

Step 3 - Assemble top. Set upright.

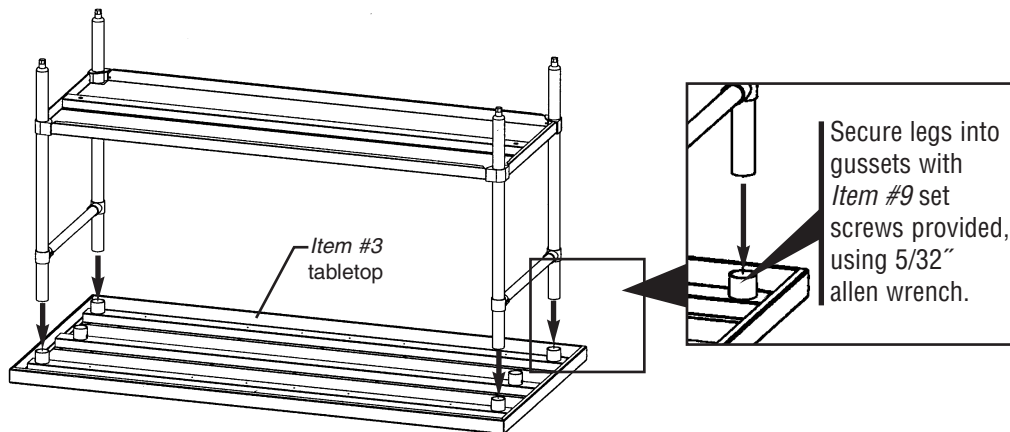

Step 4 - Assemble mirror to 78 3/8 inch legs.

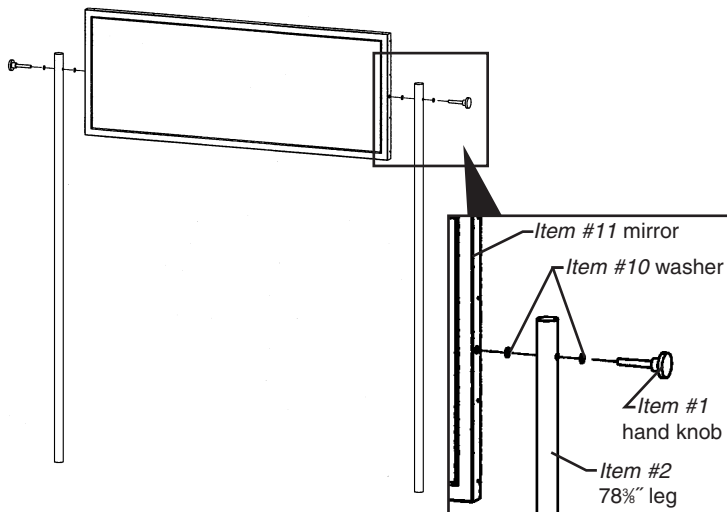

Step 5 - Attach mirror sub-assembly to table.

Secure bolts with 3/4" wrench.

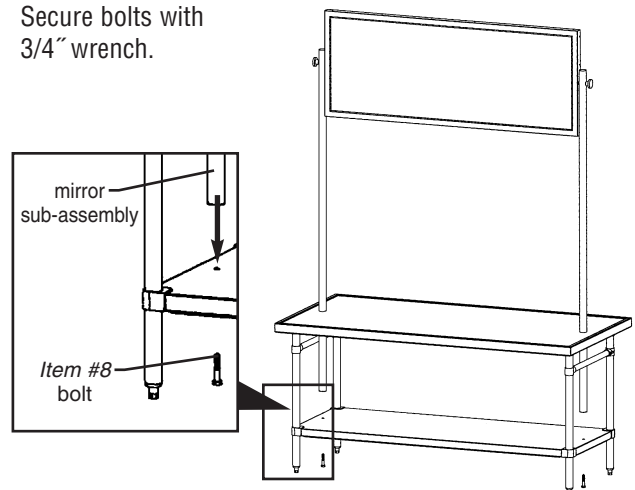

(End)