



Model: \_\_\_\_\_ Item #: \_\_\_\_\_ Date: \_\_\_\_\_

Project: \_\_\_\_\_ Qty: \_\_\_\_\_ Approved By: \_\_\_\_\_

# Self-Contained Sliding Door Back Bar Refrigeration

Refrigeration



SD60L

## Standard Features

- 36"H, 1" stainless steel top
- 25" front to back depth
- Heavy duty sliding doors with built-in locks
- Built-in Cool White LED Lighting (7000K)
- All stainless steel, coved corner interior
- Digital thermostat
- DynamicChill 360° Technology
- NSF epoxy coated durable shelves, 1 bottom & 2 adjustable shelves per door
- Pre-drilled bottom for optional legs or casters (uses 1/4"-20 self tapping 1/2" L screw)
- R290 Natural Refrigerant
- Eco-friendly refrigerant and insulation
- 5-Year compressor warranty
- 1-Year parts & labor warranty

## Models

Model	Length	Height	Depth	Compressor Side	Doors	Weight	Amps	HP
SD60L	60"	36"	25"	Left	2	360 lbs.	2.2	1/4
SD60R	60"	36"	25"	Right	2	360 lbs.	2.2	1/4
SD108L	108"	36"	25"	Left	4	720 lbs.	2.8	1/3
SD108R	108"	36"	25"	Right	4	720 lbs.	2.8	1/3

## Specifications

<b>Electrical</b>	▪ 115 V, 1 Phase, 60 Hz
	▪ Furnished with 8'-0" plug-in cord, which exits left or right rear of cooler
	▪ NEMA 5-15P plug configuration
	▪ Dedicated 15 amp circuit recommended
<b>Refrigeration</b>	▪ 2 Door Units (60"): 2.2 amps, 1/4 HP
	▪ 4 Door Units (108"): 2.8 amps, 1/3 HP
	▪ R290 Hydrocarbon Refrigerant
<b>Plumbing</b>	▪ 30°F - 40°F operating range
	▪ Digital thermostat on front grille
<b>Plumbing</b>	▪ No drain required
	▪ Condensate evaporator pan included

<b>Insulation</b>	▪ 2" thick foamed-in-place polyurethane
<b>Interior</b>	▪ 20 gauge stainless steel walls with coved corners
	▪ NSF epoxy coated durable shelves - one bottom and two adjustable shelves per door
<b>Exterior</b>	▪ Sides: 20 gauge stainless steel
	▪ Front: Glass with black vinyl doors
	▪ Back: 20 gauge galvanized steel
<b>Doors</b>	▪ Top: 1" stainless steel top
	▪ Heavy duty, glass with black vinyl sliding doors
	▪ 19-3/4"W x 29-11/16"H door opening

## Case Capacity

Model	SD60 (60")	SD108 (108")
Long Neck Bottles	15.5	30
12 oz Cans	20	40
Wine Bottles (ea)	162	288



CONFORMS TO UL Std 471 & NSF STD 7

This equipment is intended for the storage and display of non-potentially hazardous bottle or canned products only.



Model: \_\_\_\_\_ Item #: \_\_\_\_\_ Date: \_\_\_\_\_

Project: \_\_\_\_\_ Qty: \_\_\_\_\_ Approved By: \_\_\_\_\_

# Self-Contained Sliding Door Back Bar Refrigeration

Refrigeration

## Two Door (60")

Models beginning SD60

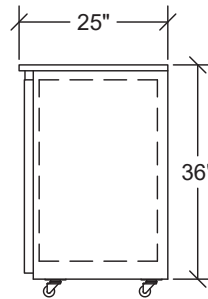
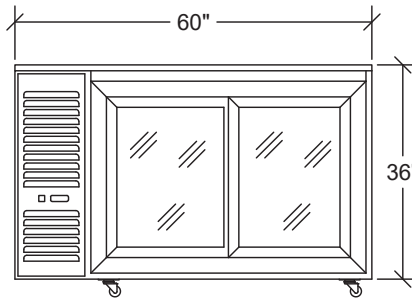
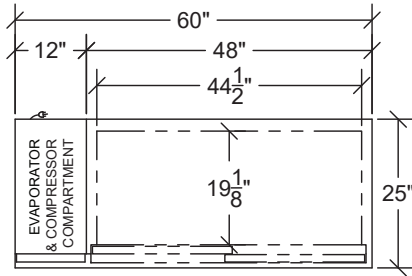

## Four Door (108")

Models beginning SD108

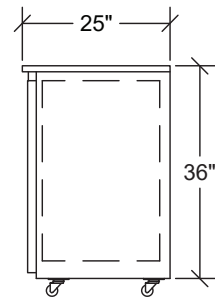
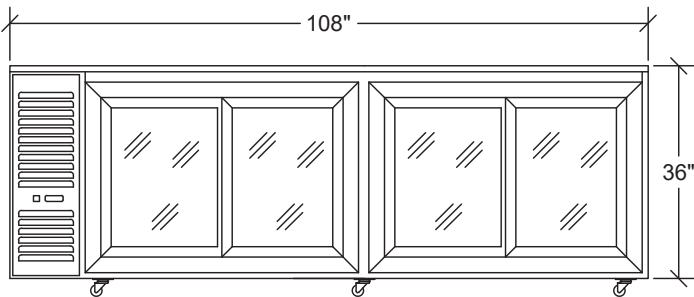
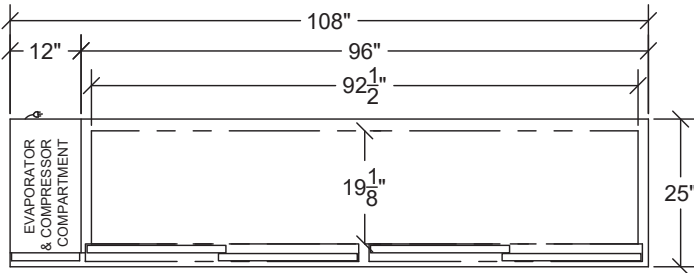

CONFORMS TO UL Std 471 & NSF STD 7

**Note:** Optional casters raise height 1" higher than wheel size  
**Note:** Optional 4" or 6" legs available

This equipment is intended for the storage and display of non-potentially hazardous bottle or canned products only.