



EVERPURE® SS-XL SCALESTICK® CARTRIDGES

INHIBITS MINERAL SCALE DEPOSITS AND PROVIDES CORROSION PROTECTION IN WATER-USING EQUIPMENT*

SS-XL Cartridge: EV9799-42



APPLICATIONS

Steamers
Combi Ovens
Ice
Coffee

Espresso
Proofers
Water-Using Equipment

FEATURES • BENEFITS

Features Hydroblend™ compound, a unique blend that inhibits mineral scale deposits and provides corrosion protection in low flow water-fed equipment*

Patented design dispenses a controlled amount of Hydroblend™ for long-term protection and provides greater effectiveness than standard phosphate treatments

Translucent cartridge allows simple visual monitoring of product usage and ensures against wasteful premature cartridge replacement

Integral feed cartridge fits most standard 10-inch housings, all current SR-X housings and all old style AR-X housings*

Larger diameter makes it suitable for small ware wash applications

Increased capacity for locations with increased scale control needs

Up to 4X the capacity of the SS-IMF (depending on the flow and water quality characteristics)

Unaffected by high temperatures, permitting use in a wide variety of applications

Designed for higher flow rates in Foodservice and light commercial applications.

Ideal for foodservice locations where SS-10 and SS-IMF cartridges are consumed before scheduled maintenance visits

INSTALLATION TIPS

The cartridge must be operated vertically. Shut-off valve must be installed upstream of the filter.

Refer to Installation, Operation & Maintenance Manual for cartridge flushing and start-up.

Pre-existing equipment scale may come loose and clog equipment. Remove any loose scale to assure satisfactory operation.

OPERATION TIPS

Deliming of equipment prior to application is recommended but not required.

Inspect ScaleStick cartridges at least every six (6) months.

Replace ScaleStick before Hydroblend compound is completely dissolved.

SIZING

Service Flow Rate: Maximum 1.0 - 060 gpm (3.7 - 22.71 Lpm)*

Treatment Capacity: Approximately 12 months. Capacity will vary depending on application and water usage. On flow rates less than 1 gpm (3.79 Lpm), capacities may be reduced*

*Not performance tested or certified by NSF®

EVERPURE® SS-XL SCALESTICK® CARTRIDGE

EV9799-42

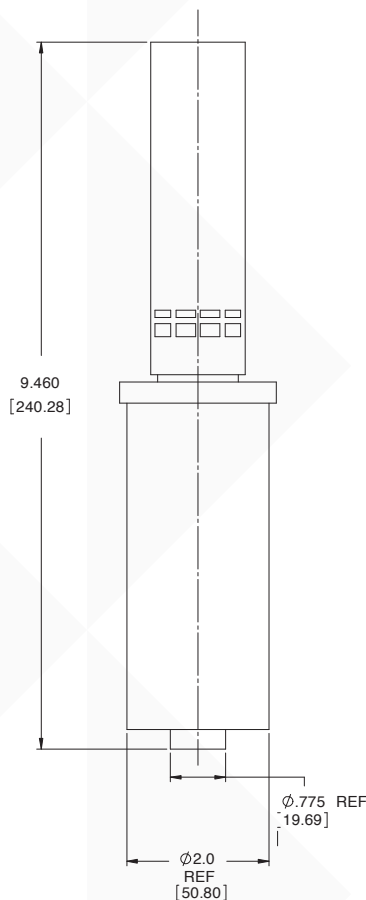

SPECIFICATIONS

Service Flow Rate

Maximum 1.0 - 060 gpm [3.7 - 22.71 Lpm]*

Treatment Capacity

Approximately 12 months. Capacity will vary depending on application and water usage. On flow rates less than one (1) gpm (3.79 Lpm), capacities may be reduced*

Maximum Temperature

150°F* (65.5°C)

Note: If inlet water temperature is above 125°F [51.67°C] a hot water housing must be used

Overall Dimensions

9.46" H x 2" dia. [24 x 5.08 cm]

Electrical Connection

None

*Not performance tested or certified by NSF



The SS-XL is Tested and Certified by NSF International against NSF/ANSI Standard 42 for material requirements only.

The contaminants or other substances removed or reduced by this drinking water system are not necessarily in your water. Do not use with water that is microbiologically unsafe or of unknown quality without adequate disinfection before or after the system. Systems certified for cyst reduction may be used with disinfected water that may contain filterable cysts.

WARRANTY

Everpure water treatment systems by Pentair® (excluding replaceable elements) are covered by a limited warranty against defects in material and workmanship for a period of five years after date of purchase. Everpure replaceable elements (filter cartridges and water treatment cartridges) are covered by a limited warranty against defects in material and workmanship for a period of one year after date of purchase. See printed warranty for details. Pentair will provide a copy of the warranty upon request.



FILTRATION & PROCESSING SOLUTIONS

EVERPURE-SHURFLO WORLD HEADQUARTERS, 1040 MUIRFIELD DRIVE, HANOVER PARK, IL 60133 USA • WWW.EVERPURE.COM
800.942.1153 MAIN (US ONLY) • 630.307.3000 MAIN • 630.307.3030 FAX • CSEVERPURE@PENTAIR.COM EMAIL

EVERPURE-SHURFLO AUSTRALIA, 1-21 MONASH DRIVE, DANDENONG SOUTH, VIC 3175, AUSTRALIA
011.1300.576.190 TEL • 011.61.39.562.7237 FAX • AU.EVERPURE@PENTAIR.COM EMAIL

EVERPURE-SHURFLO CHINA, 21F CLOUD 9 PLAZA, NO 1118, SHANGHAI, 200052, CHINA
86.21.3211.4588 TEL • 86.21.3211.4580 FAX • CHINA.WATER@PENTAIR.COM EMAIL

EVERPURE-SHURFLO INDIA, GREEN BOULEVARD, B-9/A, 7TH FLOOR - TOWER B SECTOR 62, NOIDA - 201301
91.120.419.9444 TEL • 91.120.419.9400 FAX • INDIACUSTOMER@PENTAIR.COM EMAIL

EVERPURE-SHURFLO EUROPE, PENTAIR WATER BELGIUM BVBA, INDUSTRIEPARK WOLFSTEE, TOEKOMSTLAAN, 30 B-2200 HERENTALS, BELGIUM
+32.(0).14.283.500 TEL • +32.(0).14.283.505 FAX • SALES@EVERPURE-EUROPE.COM EMAIL

EVERPURE-SHURFLO JAPAN INC., HASHIMOTO MN BLDG. 7F, 3-25-1 HASHIMOTO, MIDORI-KU, SAGAMIHARA-SHI KANAGAWA 252-0143, JAPAN
81.(0)42.775.3011 TEL • 81.(0)42.775.3015 FAX • INFO@EVERPURE.CO.JP EMAIL

EVERPURE-SHURFLO SOUTHEAST ASIA, SOUTHEAST ASIA, 390 HAVELOCK ROAD, #04-01, KING'S CENTRE, SINGAPORE 169662
65.6768.5800 TEL • 65.6737.5149 FAX • CSEVERPURE@PENTAIR.COM EMAIL

All Pentair trademarks and logos are owned by Pentair, Inc. or its affiliates. All other registered and unregistered trademarks and logos are the property of their respective owners. Because we are continuously improving our products and services, Pentair reserves the right to change specifications without prior notice. Pentair is an equal opportunity employer.