

WARING COMMERCIAL

5001C
Plastic bowl & cover

6001C
Stainless Steel bowl & cover

5001CQ CSA
Plastic bowl & cover (discontinued)

6001CQ CSA
Stainless Steel bowl & cover



015402
Name Plate

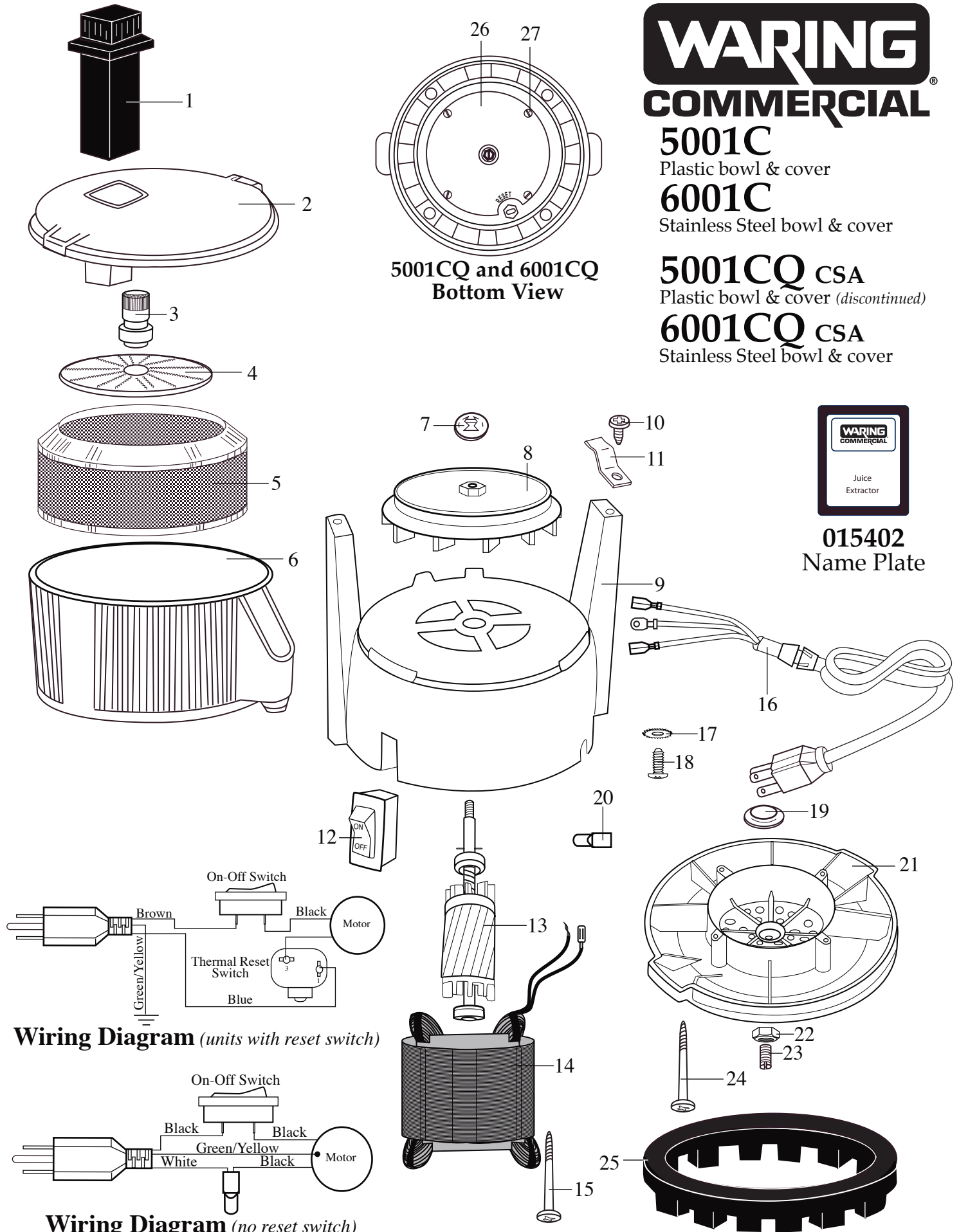

5001CQ and 6001CQ
Bottom View

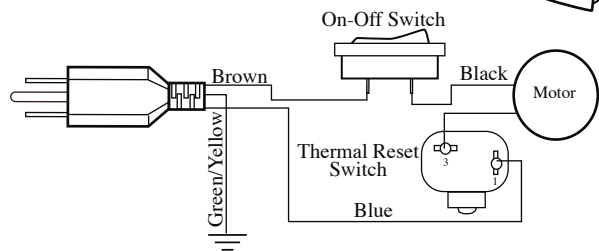

Wiring Diagram (units with reset switch)

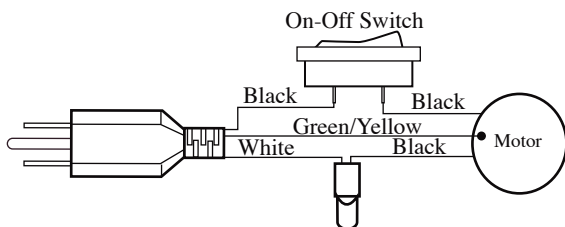

Wiring Diagram (no reset switch)

Catalog	Model
5001C	31JE26
6001C	31JE27
5001CQ	31JE36
6001CQ	31JE37

Waring Factory Service Center
 314 Ella T. Grasso Ave.
 Torrington, CT 06790
 Tele. 1-800-269-6640
 Fax 860-496-9017
 www.waringproducts.com

Illustration #	Part #	Description
1	016126	Pusher /black
2	015170	Cover /plastic
	028066	Cover /stainless steel
	015206	Cover /stainless steel (3rd, 2nd generation & older units)
3	026093	Clutch
4	015180	Shredder Plate /blade
5	015174	Strainer Basket
6	015168	Bowl /plastic
	015205	Bowl /stainless steel
7	015167	Speed Nut
8	015166-01	Impeller /white
9	015406	Upper Housing /white
10	017887	Screw 2 Req.'d
11	015178	Cover Lock 2 Req.'d
12	017245	Rocker Switch
13	026572	Rotor Assy.
	501235	Rotor Assy. (older units) - 015158 - Ball Bearing
14	029029	Stator
	502918	Stator (2nd generation)
	015176	Stator (older units)
15	015177	Screw 2 Req.'d
16	501316	Cord Set
17	015337	Washer /ground
18	002436	Screw /ground
19	015185	Support Disk 2 Req.'d
20	012409	Crimp Connector
21	015186-01-X	Bottom Housing /no reset hole
	015186-01-A	Bottom Housing (2nd generation)
	015186-01	Bottom Housing (older units)
22	015188	Hex Nut /set screw
23	015187	Set Screw
24	015177	Screw 4 Req.'d
25	016129	Foot Ring /black
26	015265	Bottom Plate /5001CQ and 6001CQ
27	015179	Screw 4 Req.'d /5001CQ and 6001CQ



015183 Reset Switch 5001C/6001C (2nd generation & older units) and 5001CQ/6001CQ Units



015184 Hex Nut /reset switch